

# DDL-8000A Series

Direct-drive, High-speed, 1-needle, Lockstitch Machine with Automatic Thread Trimmer & Auto - Lifter Motor Driven



**DDL-8000A**

**JUKI has line up a new standard model "Simple Series" to the 1-needle, lockstitch machine with Thread Trimmer.**

## The slim-sized control box and operation panel

Both the slim-sized control box and the operation panel are integrated with the machine head. The machine is provided as standard with the operation panel.

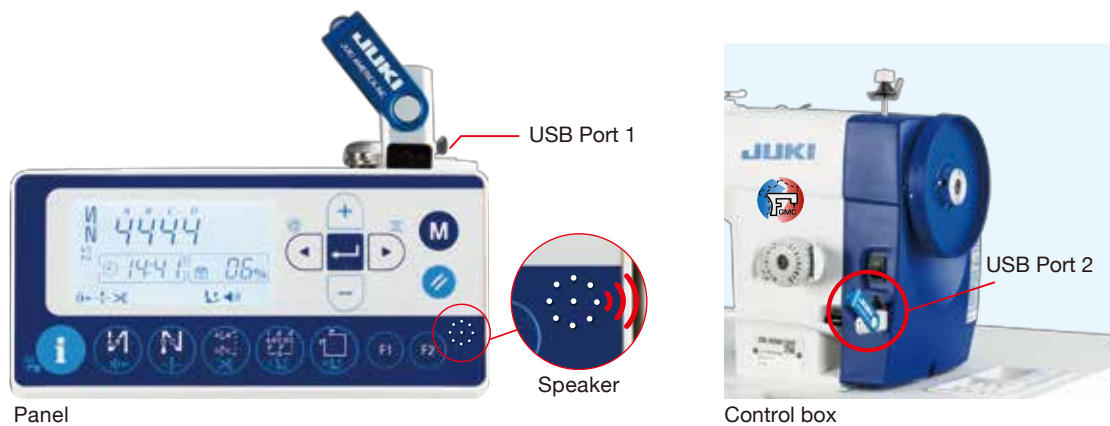

No.	Function table of operation panel
1	Stitching information
2	Production information
3	Reverse stitching pattern
4	Sewing speed
5	Bobbin thread counter
6	Error screen, etc

### Various voice guide

When the amount of oil changes to empty or full, the machine inform at voice guide.

The other voice guidance includes sewing machine operating rate, productivity achievement rate etc.

### USB Port (Two places)

The operation panel and control box are also provided as standard with a USB port.

## Standard equipment

- Auto - lifter : Motor driven more silent operation.
- The reverse feed lever, LED light, etc.

# DDL-8000A Series

## M Semi-dry head type

**DDL-8000A-MS** Max. sewing speed: 5,000sti/min

Sewing work free from oil stains by means of our leading-edge dry-head technology.

With the advanced dry technology of enabling operation without being lubricated, a frame which does not need lubrication has been developed.

It is provided with not only a high-speed sewing capability, but also a safety feature for preventing oil stains.

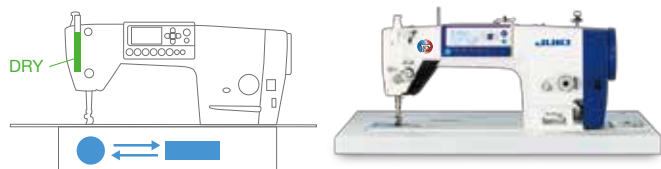

- The needle bar and thread take-up components are not lubricated.
- For the hook section, the standard method of lubrication is employed.

## S Minute-quantity lubrication type

**DDL-8000A-SH** Max. sewing speed: 4,500sti/min

The machine contributes to production improvement.

The DDL-8000A-S is the standard model developed with the emphasis on durability.

It produces seams with consistency when run at speeds which falls in the range of the highest sewing speeds.

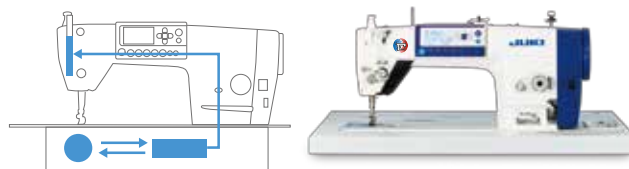

- The needle bar and thread take-up components are lubricated with the minimum required quantity of oil.
- For the hook section, the standard method of lubrication is employed.

## SPECIFICATIONS

Model name	DDL-8000AP-MS	DDL-8000AP-SH
Application	Medium-weight	Heavy-weight
Lubrication	Semi-dry	Minute-quantity lubrication
Max. sewing speed	5,000sti/min*	4,500sti/min*
Max. stitch length	5mm	
Lift of the presser foot	By hand : 5.5mm, Auto : 1st stage 8.5mm, 2nd stage 13.0mm	
Lubricating oil	JUKI Machine Oil 7 (equivalent to ISO VG7)	
Needle	DB×1(#11) #9~18 (Nm65~110)	DB×1(#21) #20~23 (Nm125~160)
Power consumption	320VA	

\*"sti/min" stands for "Stitches per Minute."

## WHEN YOU PLACE ORDERS

Please note when placing orders, that the model name should be written as follows:

### Machine head & Control box

Nipper and one-touch type reverse feed		Code
Nipper	one-touch type reverse feed	
Provided	Provided	NB

DDL8000AP   NBK

Machine head	Application	Code	Power supply	Code
Semi-dry head type	Medium-weight	MS	Single-phase 200~240V	K
Minute-quantity lubrication head type	Heavy-weight	SH		

### JUKI ECO PRODUCTS

The DDL-8000A is an eco-friendly product which complies with JUKI ECO PRODUCTS standards for protecting the environment.



- The sewing machine complies with the "Juki Group Green Procurement Guidelines" on the use of hazardous substances, which is stricter than other restrictions, such as those of the RoHS Directive.

For details of JUKI ECO PRODUCTS, refer to: [http://www.juki.co.jp/eco\\_e/index.html](http://www.juki.co.jp/eco_e/index.html)

\*The RoHS Directive is an EU Directive limiting the use of 6 hazardous substances (lead, hexavalent chromium, mercury, cadmium, PBB and PBDE) in electrical and electronic equipment. The Juki Green Procurement Guideline is the voluntarily established criteria to eliminate not only the aforementioned six substances, but also other ones which also adversely affect the environment.



Registered Organization : JUKI CORPORATION Head Office  
The Scope of the Registration : The activities of research, development, design, sales, distribution, and maintenance services of industrial sewing machines, household sewing machines and industrial robots, etc., including sales and maintenance services of data entry systems.

**JUKI**  
JUKI CORPORATION  
SEWING MACHINERY & SYSTEMS BUSINESS UNIT

France Général Machines à Coudre  
Réparation • Vente • Achat • Location

FRANCE GENERAL MACHINES A COUDRE  
13 Chemin du Génie 69200 Vénissieux  
Tél : +33(0) 4 78 68 66 62 + 33(0)6 45 58 79 03  
E mail : [contact@fgmc.pro](mailto:contact@fgmc.pro)  
<https://francegeneralmachinesacoudre.fr>

- \* Specifications and appearance are subject to change without prior notice for improvement.
- \* Read the instruction manual before putting the machine into service to ensure safety.
- \* This catalogue prints with environment-friendly soyink on recycle paper.
- \* Paper from responsible sources FSC™ C001712